

3 SECTION AA

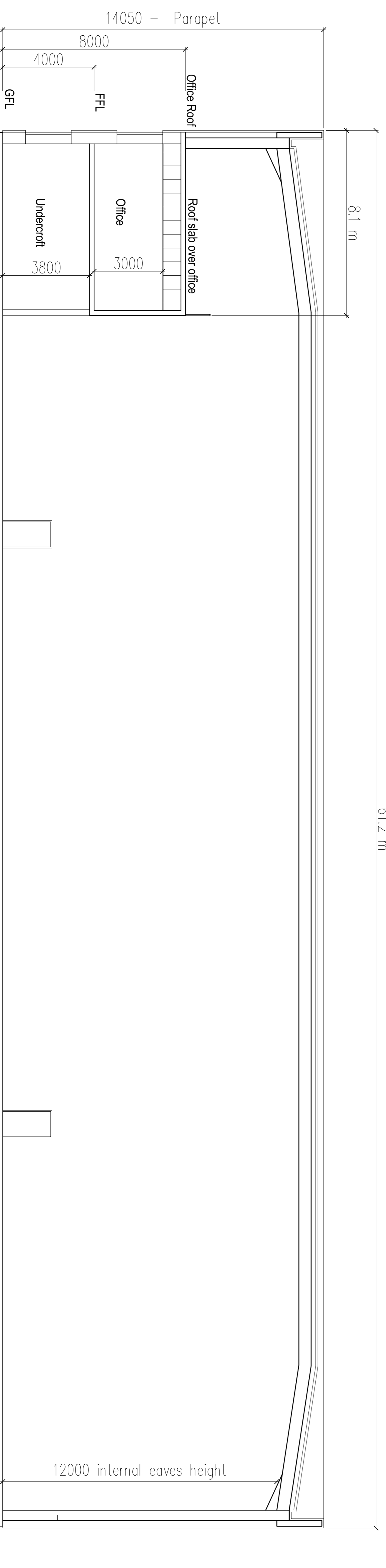

4 SECTION B-B

DUBLIN AIRPORT LOGISTICS PARK - CONDOR HOUSE - SECTIONS

DEVELOPED BY:



Rohan Holdings Limited
 4th Floor, Block 2, Harcourt Centre,
 Harcourt Street, Dublin 2.
 T: (01) 662 4455 E: info@rohanholdings.ie
 W: www.rohanholdings.ie

AGENT:

Savills Dublin Commercial
 33 Molesworth Street
 Dublin 2
 T: +353 (0) 1 618 1300
 E: industrial234@savills.ie
 W: www.savills.ie



46 Upper Mount Street 1 +353 1 202 7000 www.totp.ie
 Dublin 2, Ireland +353 866005070 info@totp.ie

PROJECT:
ROHAN HOLDINGS
DUBLIN AIRPORT LOGISTICS PARK

STAGE:
MARKETING

DRAWING TITLE:
CONDOR HOUSE
SECTIONS

DATE: JANUARY 2016 DRAWING NO:
P-302a

SCALE: 1:100
 DRAWN: NW
 CHECKED: OS
 JOB NO.: 1574 SHEET SIZE: RENSIGN
 FILE NAME: A1L *