

Schedule of Approximate Gross External Floor Areas (GEA)	
Warehouse	4941
Office (Ground)	251
Office (First)	289
<b>Total</b>	<b>5481 sq.m (GEA)</b>

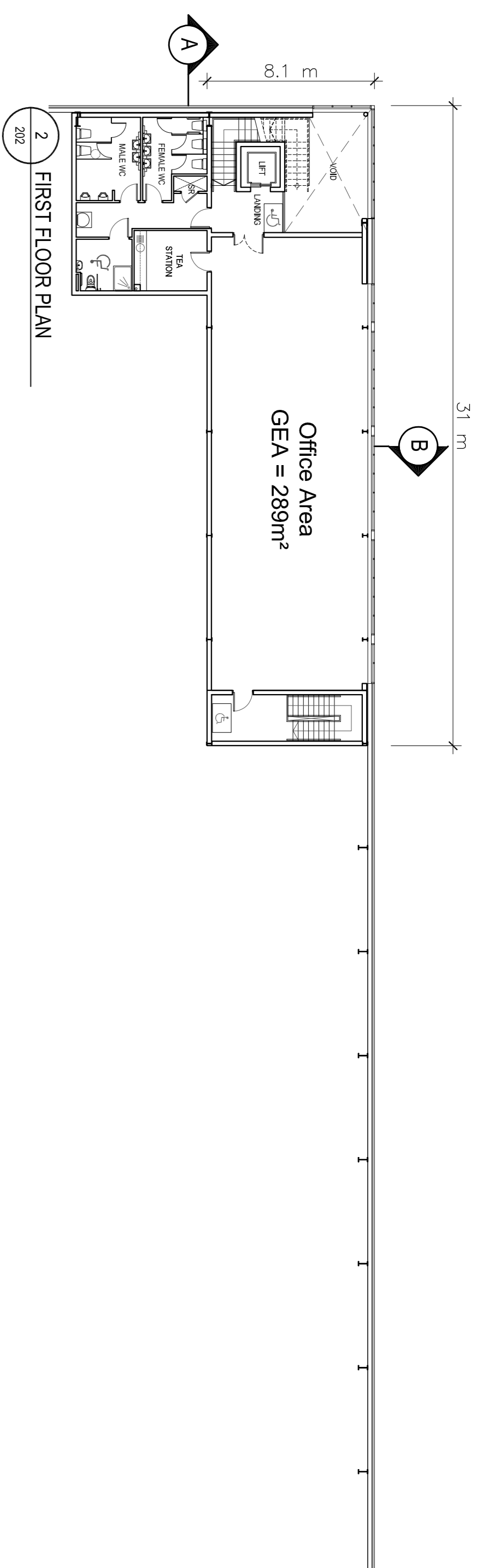

# DUBLIN AIRPORT LOGISTICS PARK - OSPREY HOUSE - PLANS

DEVELOPED BY:



**Rohan Holdings Limited**  
 4th Floor, Block 2, Harcourt Centre,  
 Harcourt Street, Dublin 2.  
 T:(0)1 662 4455 E:info@rohanholdings.ie  
 W:www.rohanholdings.ie

AGENT:

**Savills Dublin Commercial**  
 33 Molesworth Street  
 Dublin 2  
 T: +353 (0) 1 618 1300  
 E: industrial234@savills.ie  
 W: www.savills.ie



46 Upper Mount Street 1 +353 1 202 7000 www.totp.ie  
 Dublin 2, Ireland +353 866005070 info@totp.ie

PROJECT:

**ROHAN HOLDINGS  
 DUBLIN AIRPORT LOGISTICS PARK**

STAGE:

**MARKETING**

DRAWING TITLE:

**OSPREY HOUSE  
 FLOOR PLANS**

DATE: JANUARY 2016 DRAWING NO: P-202

SCALE: 1:200

DRAWN: NW

CHECKED: OS SHEET SIZE: RENSIGN

JOB NO.: 1574 FILE NAME: A1L \*