

NOTES:
DO NOT SCALE
DIMENSIONS ARE APPROXIMATE
FOR INFORMATION PURPOSES ONLY
SUBJECT TO CONTRACT/CONTRACT DENIED

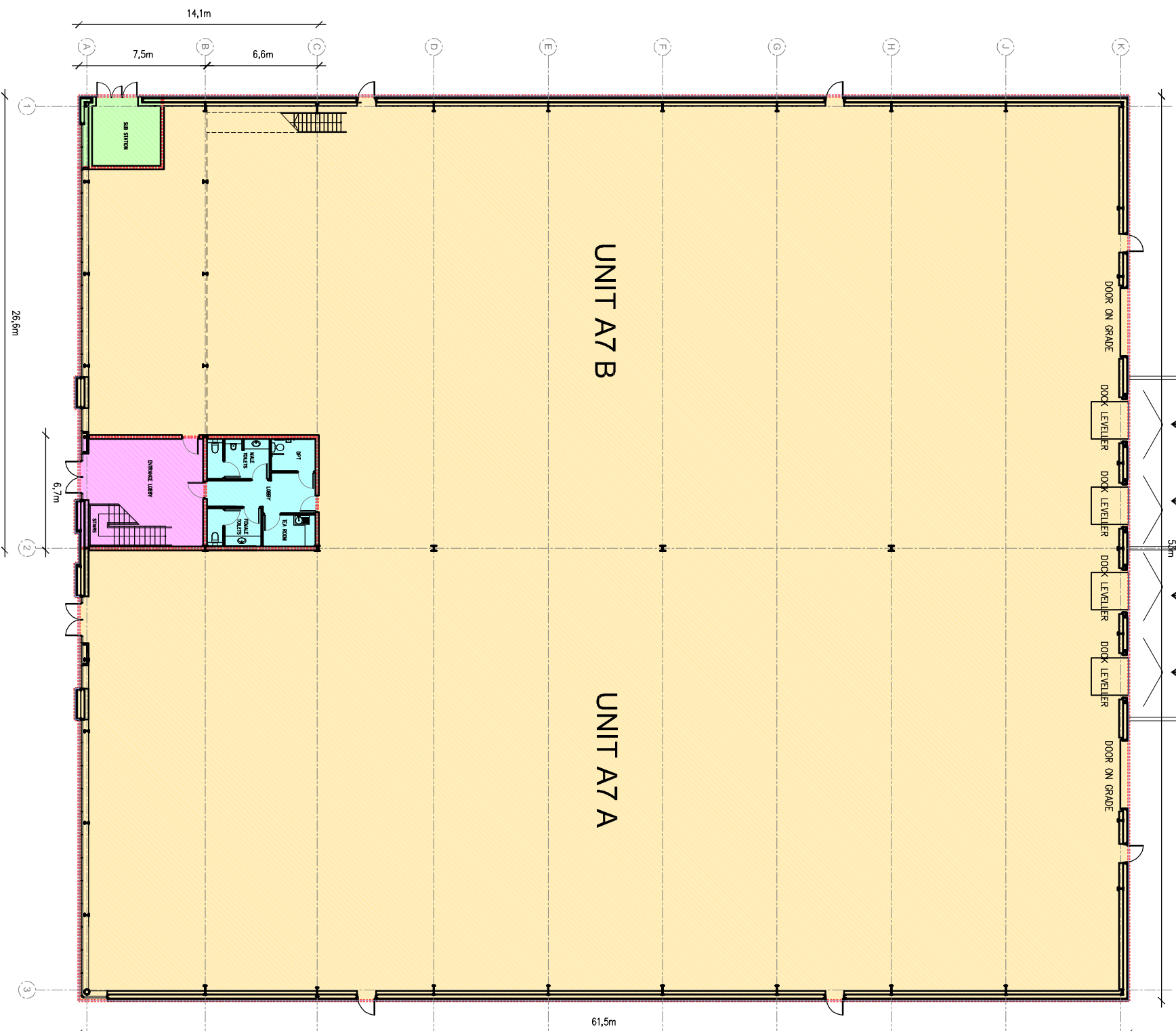
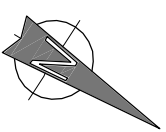

UNIT A7 - Gross Ext Area

TOTAL GEA = 3,504.5 m²
FOOTPRINT = 3,280 m²

- WAREHOUSE
3,148.5 m²
- WAREHOUSE TOILETS
42.5 m²
- OFFICE CORE
48.5 m²
- ESB SUB-STATION
20.5 m²

The Developer reserves the right to alter plans, specifications & layout.
No allowance is made for the accuracy of the copying process.

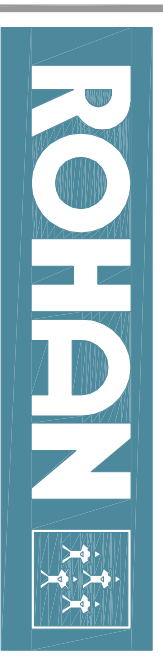

DEVELOPER: Rohan Holdings Limited
4th Floor, Block 2, Harcourt Centre, Harcourt Street, Dublin 2.
Tel +353 (0)1 662 4455 Fax +353 (0)1 676 5404
Email: info@rohanholdings.ie
www.rohanholdings.ie

AGENT: Savills Commercial Ireland
33 Molesworth Street, Dublin 2.
Phone : +353 (0) 1 618 1300
Email: info@savills.ie
www.savills.ie



ARCHITECTS: JSA Architects
10 Booterstown Avenue, Blackrock, Co. Dublin.
Phone: Phone :+353 (0) 1 288 2661
Email: jse@jsarch.ie
www.jsarch.ie

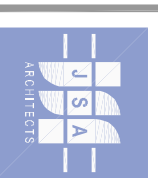

North City Business Park - Unit A7a / A7b Combined - GROUND FLOOR PLAN